

CATALOGO 2016



FARETTI PEDONABILI A LED  
IN ALLUMINIO RESINATI IP67



## 1 USCITA LUMINOSA

Segnapasso da esterno in alluminio. Ideale per vialetti, terrazzi, scale.



Non incluso



0.5 WATT  
TOTALI

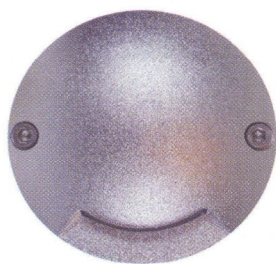

**Alimentaz.** 12Vdc  
**Nr. LED** 4  
**Lente** 1x80°

**Codice**  
PSELOE061R

**Finitura**  
GRIGIA

**Luce**  
NEUTRA

**Confezione** SACCHETTO

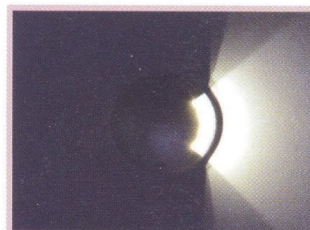

CE

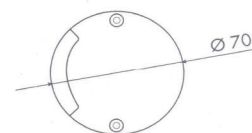

## 2 USCITE LUMINOSE

Segnapasso da esterno in alluminio. Ideale per vialetti, terrazzi, scale.



Non incluso



0.8 WATT  
TOTALI

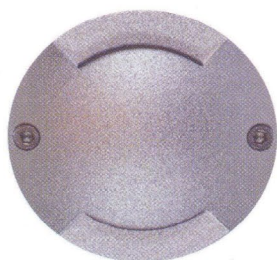

**Alimentaz.** 12Vdc  
**Nr. LED** 8  
**Lente** 2x80°

**Codice**  
PSELOE062R

**Finitura**  
GRIGIA

**Luce**  
NEUTRA

**Confezione** SACCHETTO



CE

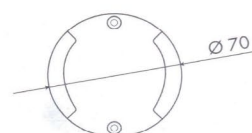

## 4 USCITE LUMINOSE

Segnapasso da esterno in alluminio. Ideale per vialetti, terrazzi, scale.



Non incluso



1 WATT  
TOTALI



**Alimentaz.** 12Vdc  
**Nr. LED** 12  
**Lente** 4x50°

**Codice**  
PSELOE064R

**Finitura**  
GRIGIA

**Luce**  
NEUTRA

**Confezione** SACCHETTO



CE

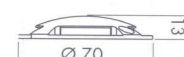
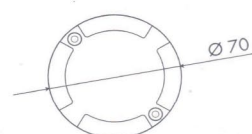

# CASE IP67



## LPV-20/35/60/100/150

### Uscita Tensione Costante (LPV)

Ingresso Range Universale 90-264Vac  
 Classe II. No messa a terra  
 Case in plastica isolato IP67  
 Elevata affidabilità  
**Adatto per illuminazioni LED**

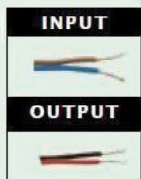

Dimensioni (LxWxH)(mm)	118x 35x 26	148x 40x 30
------------------------	-------------	-------------

**LPV-20**

Modello No.	Output	Tol.	R&N	Effi.
LPV-20-12	12V, 0~1.67A	±5%	120mV	81%

**LPV-35**

Modello No.	Output	Tol.	R&N	Effi.
LPV-35-12	12V, 0~3A	±5%	120mV	84%

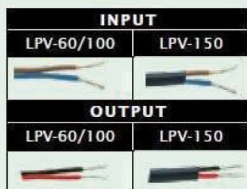
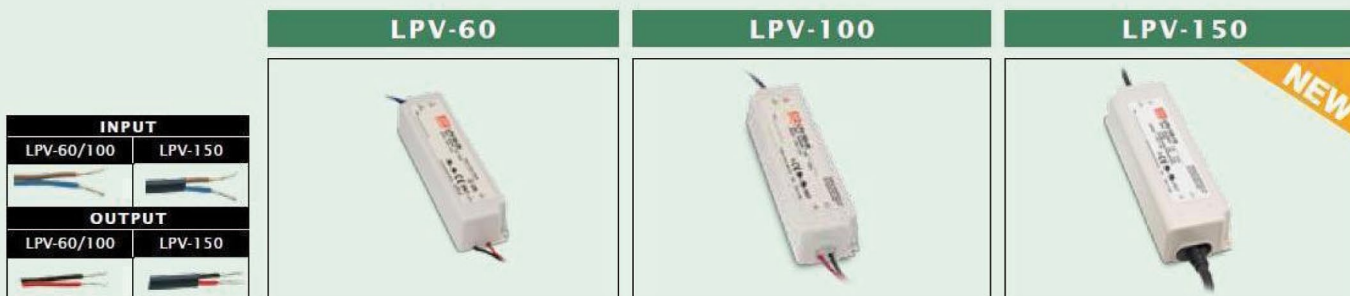

Dimensioni (LxWxH)(mm)	162.5x 42.5x 32	190x 52x 37	191x 63x 37.5
------------------------	-----------------	-------------	---------------

**LPV-60**

Modello No.	Output	Tol.	R&N	Effi.
LPV-60-12	12V, 0~5A	±5%	120mV	83%

**LPV-150**

Modello No.	Output	Tol.	R&N	Effi.
LPV-150-12	12V, 0~10A	±5%	200mV	87%

**LPV-100**

Modello No.	Output	Tol.	R&N	Effi.
LPV-100-12	12V, 0~8.5A	±5%	120mV	85%

**SONO FORNIBILI SU SPECIFICA RICHIESTA ALTRI TIPI E MODELLI DI ALIMENTATORI**



**PADOVA STRUMENTI ELETTRICI S.R.L.**

Via Matteotti 3

35010 Vigodarzere (Pd)

tel/fax 049/8871149

email: [amministrazione@elettropse.com](mailto:amministrazione@elettropse.com)

[www.elettropse.com](http://www.elettropse.com)